

PEUGEOT THERMOSTATS

Model	cyl.	cc	Engine	From	To	Cat. No.	°C	Style	D1	D2	H	Styles
1007 1.4		1.4	KFV	04/05		7.8308	86	C				 <p>STYLE A Top flange only</p>
1007 1.4 16V		1.4	KFU (ET3J4)	10/05		7.8671	91	C				
1007 1.4 HDi		1.4	8HX (DV4TD), 8HZ (DV4TD)	04/05	10/08	7.8486	83	C				
1007 1.4 HDi		1.4	8HX (DV4TD), 8HZ (DV4TD)	11/08		7.8734	83	C				
1007 1.6 16V		1.6	NFU (TU5JP4)	04/05		7.8671	91	C				
1007 1.6 HDi		1.6	9HZ (DV6TED4)	06/07		7.8734	83	C				
104		0.9-1.4		10/72	06/88	7.8240	83	A	54			
106		1.0-1.6		09/91	04/96	7.8290	89	A	54			
106 Diesel		1.4,1.5	K9Y (TUD3Y)	09/92	04/96	7.8389	89	B	46	29	35	
106		1.0-1.6		05/96		7.8290	89	A	54			
107		1.0	1KR (384 F)	06/05	05/14	7.8674	82	B	52	33	50	
107 Diesel		1.4	8HT (DV4TD)	06/05	05/14	7.8486	83	C				
108		1.0	1KR (384 F)	05/14	04/18	7.8674	80	B	52	33	50	
2008 Vti		1.6	EP6C	05/13		7.8866	107	C				
205		1.0-1.6		10/87	09/98	7.8290	89	A	54			
205		1.9	DKZ (XU9JAZ)	10/87	10/94	7.8240	83	A	54			
205 Diesel		1.7,1.9	161A (XUD7)	07/87	09/98	7.8250	81	B	68	29	26	
206		1.1	HFX (TU1JP), HFZ (TU1JP)	09/98	06/13	7.8191	89	C				
206 Diesel		1.4	8HX (DV4TD), 8HZ (DV4TD)	09/01		7.8486	83	C				
206		1.4	K6,KF	09/98	04/05	7.8191	89	C				
206		1.4	K6,KF	05/05		7.8671	91	C				
206		1.4	TU3A	01/09	08/13	7.8191	89	C				
206		1.6	N6, NFU	09/98	04/05	7.8191	89	C				
206		1.6	N6, NFU	05/05		7.8671	91	C				
206 Diesel		1.6	9HY (DV6TED4), 9HZ (DV6TED4)	05/04		7.8708	83	C				
206 Diesel		1.9	WJY (DW8B)	02/99		7.8323	83	B	55	29	35	
207 Diesel		2.0	RHY (DW10TD)	12/99		7.8323	83	B	55	29	35	
206		2.0	RF	04/99		7.8423	89	C				
207 16V		1.4	KFU (ET3J4)	02/06	10/13	7.8671	91	C				
207 16V		1.4	EP3	10/09	06/10	7.8863	107	C				
207 16V		1.4	EP3	07/10		7.8866	107	C				
207 16V		1.4	EP3C 8FR,8FS	06/07	10/13	7.8863	107	C				
207 Diesel		1.4	DV4 Turbo	02/06	11/08	7.8486	83	C				
207 Diesel		1.4	DV4 Turbo	12/08	12/15	7.8734	83	C				
207		1.6	NFU, N6A, TU5JP4	02/06	12/13	7.8671	91	C				
207		1.6	5FS, EP6C	06/07	06/10	7.8863	107	C				
207		1.6	5FS, EP6C	07/10	10/13	7.8866	107	C				
207		1.6	5F, EP6DT Turbo	02/07	09/10	7.8927	107	C				
207 Diesel		1.6	9HX,9HY,DV6TED4 Turbo	02/06	02/07	7.8708	83	C				
207 Diesel		1.6	9HX,9HY,DV6TED4 Turbo	02/07	10/13	7.8734	83	C				
208		1.4	EP3C	10/13		7.8866	107	C				
208		1.6	EP6C	03/12		7.8866	107	C				
3008		1.6	EP6C	06/09	06/10	7.8863	107	C				
3008		1.6	EP6C	07/10	08/16	7.8866	107	C				
3008		1.6	EP6DT Turbo	06/09	08/16	7.8927	107	C				
3008 Diesel		2.0	RHH, DW10CTED4	06/09	08/16	7.8790	83	C				
301		1.6	EC5	11/12	10/17	7.8671	91	C				
305		1.3,1.5,1.6,1.9		10/82	12/88	7.8240	83	A	54			
305 Diesel		1.9	162 (XUD9)	10/82	07/88	7.8250	81	B	68	29	26	
306		1.1	HDZ (TU1M)	06/94	05/01	7.8290	89	A	54			
306		1.4	TU3	01/93	04/97	7.8290	89	A	54			
306		1.4	KFW (TU3JP), KFX (TU3JP)	06/94	04/99	7.8290	89	A	54			
306		1.4	KFW (TU3JP), KFX (TU3JP)	05/99	07/01	7.8308	86	C				
306		1.6	NFT	10/00	04/02	7.8191	89	C				
306		1.6	NFZ (TU5JP)	05/93	05/01	7.8290	89	A	54			
306		1.6	NFZ (TU5JP)	05/99	10/00	7.8308	86	C				

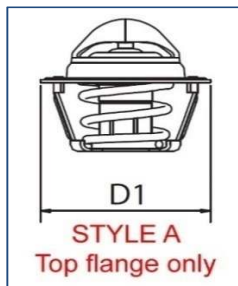
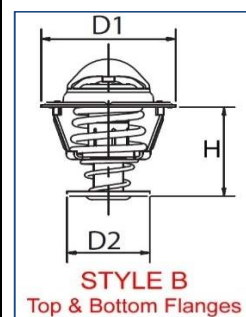

STYLE C
With housing
see below.

If model or series not listed,
please contact us
for assistance.

Email Enquiries:
sales@autoagencies.co.nz

E. & O.E.

Model	cyl.	cc	Engine	From	To	Cat. No.	°C	Style	D1	D2	H
306		1.8	LFY (XU7JP4)	03/97	05/01	7.8304	92	A	55		
306		1.8	LFZ (XU7JP)	06/94	05/01	7.8240	83	A	54		
306 Diesel		1.9, 2.0	DHY,DJY,DJZ,RHY,WJY	06/94	05/01	7.8323	83	B	55	29	35
306		2.0	RFV (XU10J4R)	03/97	05/01	7.8304	92	A	55		
306		2.0	RFX (XU10J2)	07/94	05/01	7.8290	89	A	54		
307		1.4	TU3JP, ET3J4	08/00	06/05	7.8191	89	C			
307		1.4	ET3J4	07/05	07/07	7.8671	91	C			
307 Diesel		1.4	8HX (DV4TD), 8HZ (DV4TD)	10/01	06/05	7.8486	83	C			
307		1.6	N6A,NFU (TU5JP4)	08/00	06/05	7.8191	89	C			
307		1.6	N6A,NFU (TU5JP4)	07/05	04/09	7.8671	91	C			
307 Diesel		1.6	9HV (DV6TED4)	04/05	05/07	7.8708	83	C			
307 Diesel		1.6	9HV (DV6TED4)	06/05	03/09	7.8734	83	C			
307		2.0	RF (EW10)	03/02	04/09	7.8423	89	C			
307		2.0	EW10A With Sensor	06/05		7.8CTK126	105	C			
307 Diesel		2.0	RHY (DW10TD), RHS RHZ (DW10ATED)	08/00	03/07	7.8323	83	B	55	29	35
307 Diesel 135		2.0	RHR (DW10BTED4)	12/04	04/08	7.8748	83	C			
308		1.4	EP3	09/07	10/14	7.8863	105	C			
308		1.4	EP3C	12/09	08/10	7.8863	105	C			
308		1.4	EP3C	08/10	10/14	7.8866	105	C			
308		1.6	N6A (TU5JP4)	07/08		7.8671	91	C			
308		1.6	EP6C	07/10		7.8866	105	C			
308		1.6	EP6 Manual	09/07	10/14	7.8863	83	C			
308		1.6	EP6 Automatic	09/07	10/14	7.8927	105	C			
308		1.6	EP6DT, EP6DTS	03/08	10/14	7.8927K	105	C			
308		1.6	EC5	11/12		7.8671	91	C			
308 Diesel		1.6	9HV (DV6TED4)	09/07	10/14	7.8734	83	C			
308		2.0	RFJ (EW10A)	09/07	12/14	7.8423	89	C			
308 Diesel		2.0	(DW10BTED4)	09/07	12/14	7.8748	83	C			
309		1.1,1.4,1.6,1.9	H1B (TU1)	09/89	10/93	7.8290	89	A	54		
309 Diesel		1.9	162 (XUD9), D9A (XUD9), DJZ (XUD9Y)	07/89	12/93	7.8323	83	B	55	29	35
4007		2.0	4B11	11/10	03/13	7.8222	82	B	56	28	36
4007 Diesel		2.2	DW12M	02/07	03/13	7.8747	83	C			
4007		2.4	4B12	02/07	03/13	7.8222	82	B	56	28	36
4008		1.6	MMC, 4A92	05/12		7.8850	87	A	52		
4008 Diesel		1.8	4N13	05/12		7.8399S	82	B	56	28	43
4008		2.0	4B11	04/12		7.8222	82	B	56	28	36
405		1.4	TU 3	01/87	12/96	7.8290	89	A	54		
405		1.6	B1E,BDY,BDZ	07/87	12/96	7.8240	83	A	54		
405		1.8	LFZ	08/92	10/95	7.8240	83	A	54		
405 Diesel		1.8,1.9	XUD7,XUD9,DJY,DJZ	01/87	10/95	7.8323	83	B	55	29	35
405		1.9	D2C,D6A,DDZ,XU9	07/87	12/92	7.8240	83	A	54		
405		2.0	RFX	08/92	10/95	7.8240	83	A	54		
406		1.6	BFZ (XU5JP)	11/95	05/04	7.8240	83	A	54		
406		1.8	LFX (XU7JB)	10/96	05/04	7.8240	83	A	54		
406		1.8	LFY (XU7JP4)	11/95	10/00	7.8304	92	A	55		
406		1.8	6FZ (EW7J4)	10/00	05/04	7.8423	89	C			
406 Diesel		1.9,2.0,2.2	DHW,DHX,DHY,RHS,RHY, RHZ,4HX	10/96	05/04	7.8323	83	B	55	29	35
406 Diesel		2.1	P8C (XUD11BTE)	01/96	10/04	7.8310	85	A	68		
406		2.0	RFV (XU10J4R)	11/95	05/04	7.8304	92	A	55		
406		2.0	RFN,RFR,RLZ (EW10J4)	08/00	05/04	7.8423	89	C			
406		2.0	RGX (XU10J2TE) Turbo	04/96	05/04	7.8240	83	A	54		
406		2.2	3FZ (EW12J4)	07/00	05/04	7.8423	89	C			
406	6	3.0	XFZ,XFZ (ES9J4)	10/96	05/04	7.8510	82	C			
407 Diesel		1.6	9HZ (DV6TED4)	05/04	06/07	7.8708	83	C			
407 Diesel		1.6	9HZ (DV6TED4)	06/07	12/10	7.8734	83	C			
407		1.8	EW7	05/04	12/10	7.8423	89	C			
407		2.0	EW10	05/04	12/10	7.8423	89	C			
407		2.0	EW10 with sensor	09/05		7.8CTK126	105	C			
407 Diesel		2.0	RHL (DW10BTED4)	02/05	12/10	7.8748	83	C			
407		2.2	EW12	05/04	12/10	7.8423	89	C			

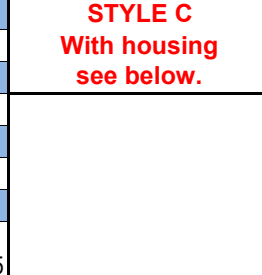
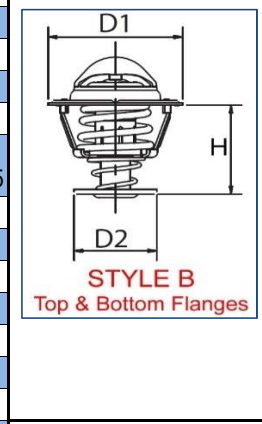

If model or series not listed,
please contact us
for assistance.

Email Enquiries:
sales@autoagencies.co.nz

E. & O.E.

Model	cyl.	cc	Engine	From	To	Cat. No.	°C	Style	D1	D2	H	Styles
407 Diesel		2.2	DW12BT	05/06	12/10	7.8747	83	C				
407 Diesel		2.7	UHZ (DT17)	10/05	12/10	7.8685	88	B	44	35	33	
407	6	3.0	XFV (ES9A)	05/04		7.8510	82	C				
407 Diesel	6	3.0	DT20C	06/09		7.8685	88	B	44	35	33	
5008		1.6	5FS, EP6C	09/09	07/10	7.8863	105	C				
5008		1.6	5FS, EP6C	07/10		7.8866	105	C				
5008 Diesel		1.6	DV6TED4	09/09		7.8734	83	C				
5008 Diesel		2.0	RHH, DW10CTED4	09/09		7.8790	83	C				
508		1.6	EP6C	11/10		7.8866	105	C				
508 Diesel		2.0	DW10C	11/10		7.8790	83	C				
508 Diesel		2.0	DW10BTED4	03/13		7.8748	83	C				
508 Diesel		2.2	DW12C	11/10		7.8747	83	C				
605		2.0	RFZ R5A (XU10J2Z)	06/89	09/99	7.8240	83	A	54			
605		2.0	RFV (XU10J4R)	07/94	09/99	7.8304	92	A	55			
605		2.0	RGX RGY (XU10J2TE) Turbo	07/91	09/99	7.8240	83	A	54			
605 2.1 Turbo Diesel		2.1	PHZ (XUD11ATE)	06/89	09/99	7.8310	85	C				
607		2.0	RFN (EW10J4)	02/00	08/05	7.8423	89	C				
607 Diesel		2.0	RHS RHZ (DW10ATED)	03/01	07/04	7.8323	83	B	55	29	35	
608 Diesel		2.0	RHL RHR (DW10BTED4)	09/05	07/11	7.8748	83	C				
607		2.2	3F (EW12J4)	02/00	06/10	7.8423	89	C				
607 Diesel		2.2	4HX (DW12TED4/FAP)	02/00	02/06	7.8323	83	B	55	29	35	
607 Diesel		2.2	4H (DW12BTED4)	05/06		7.8747	83	C				
607 Diesel		2.7	DT17TED4	12/04	07/11	7.8685	88	B	44	35	33	
607	6	3.0	XF (ES9J4S)	02/00	07/11	7.8510	82	C				
806		1.8	LFW (XU7JP)	07/95	08/02	7.8240	83	A	54			
806 Diesel		1.9	DH (XUD9TE)	07/95	08/02	7.8323	83	B	55	29	35	
806		2.0	RFU (XU10J2)	06/94	08/02	7.8240	83	A	54			
806		2.0	RFN (EW10J4)	09/00	08/02	7.8191	89	C				
806		2.0	RFV (XU10J4R)	05/98	09/00	7.8304	92	A	55			
806		2.0	RGX (XU10J2TE) Turbo	06/94	08/02	7.8240	83	A	54			
806 Diesel		2.0,2.1	P8C RH (DW10ATED)	06/96	08/02	7.8323	83	B	55	29	35	
807 2.0		2.0	RFJ RFN (EW10J4)	06/02		7.8423	89	C				
807 Diesel		2.0	RHR (DW10BTED4)	06/06		7.8748	83	C				
808 Diesel		2.0	RHM RHT RHW (DW10ATED4)	06/02	02/06	7.8323	83	B	55	29	35	
809 Diesel		2.0	RHM RHT RHW (DW10UTED4)	02/06		7.8748	83	C				
807 Diesel		2.0	(DW10CTED4) (DW10CBDTR/FAP)	06/09		7.8790	83	C				
807 2.2		2.2	3FZ (EW12J4)	06/02		7.8423	89	C				
807 Diesel		2.2	4HX (DW12TED4/FAP)	06/02	05/06	7.8323	83	B	55	29	35	
807 Diesel		2.2	4HT (DW12BTED4)	06/06		7.8747	83	C				
807	6	3.0	XFW XFX (ES9J4S)	06/02		7.8510	82	C				
BOXER Diesel		2.2	4HV (P22DTE)	04/06		7.8412	88	B	52	28	33	
BOXER Diesel		3.0	F30DT	02/07		7.8942	79	Kit				
EXPERT		1.8	L6B LfZ (XU7JP)	09/96		7.8240	83	A	54			
EXPERT Diesel		1.9	D8B D9B DHX (XUD9AU) (XUD9TE)	02/96	12/06	7.8323	83	B	55	29	35	
EXPERT		2.0	RFN (EW10J4)	07/00	12/06	7.8191	89	C				
EXPERT Diesel		2.0	RHW RHX (DW10ATED4) (DW10BTED4)	07/00	08/09	7.8323	83	B	55	29	35	
EXPERT Diesel		2.0	RH (DW10CTED4)	09/09		7.8790	83	C				
EXPERT Diesel		2.2	4H (P22DTE)	04/06		7.8412	88	B	52	28	33	
PARTNER		1.1	HDY HDZ (TU1M)	06/96	09/05	7.8290	89	A	54			
PARTNER		1.1	TU1JP	06/96	09/05	7.8191 or 7.8308	89 86	C				
PARTNER		1.4	KFX (TU3JP), TU32	06/96	12/15	7.8308	86	C				
PARTNER		1.6	(TU5JP)	09/00	10/02	7.8308	86	C				
PARTNER		1.6	(TU5JP)	10/02	11/05	7.8191	89	C				
PARTNER		1.6	(TU5JP)	11/05		7.8671	91	C				
PARTNER Diesel		1.6	DV6ATED4	02/06	12/15	7.8708	83	C				
PARTNER Diesel		1.6	DV6BTED5	06/07	12/13	7.8734	83	C				
PARTNER		1.6	5FK (EP6CB)	04/10		7.8866	105	C				

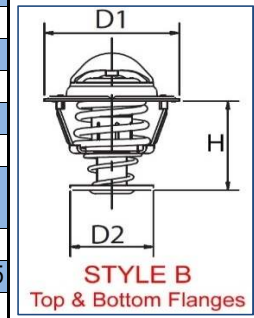

STYLE C
With housing
see below.

If model or series not listed,
please contact us
for assistance.

Email Enquiries:
sales@autoagencies.co.nz

E. & O.E.

PARTNER	1.8	XU7JB	03/97	12/03	7.8240	83	A	54	35
PARTNER Diesel	1.8	161A (XUD7)	06/96	12/02	7.8323	83	B	55	29
PARTNER Diesel	1.9	XUD9	06/96	12/15	7.8323	83	B	55	29
PARTNER Diesel	2.0	RHY (DW10TD)	04/00	07/08	7.8323	83	B	55	29
RCZ Diesel	2.0	DW10CTED4	03/10	12/15	7.8790	83	C		

